

STATE OF NORTH CAROLINA
DEPARTMENT OF TRANSPORTATION

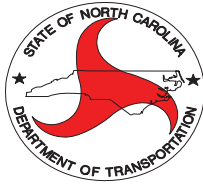

DIVISION FOUR

CONTRACT

WBS Element: 4CR.20511.14 State Funded

County: Johnston

Description: Contract Resurfacing

Length: 17.24 Miles

Location: 20 Sections of Secondary Roads

Contractor: S. T. Wooten Corp.

Address: PO Box 2408
Wilson, NC 27894

Division Engineer: R. E. Greene, Jr., PE

Resident Engineer: Corey McLamb, PE

Purchase Order No. 3600025134

Bids Opened: June 4, 2009

Availability Date: July 8, 2009

Completion Date: June 30, 2010

WBS ELEMENT	SHEET NO.	TOTAL NO.
4CR.20511.14		

SUMMARY OF QUANTITIES

WBS ELEMENT	COUNTY	MAP NO	ROUTE	DESCRIPTION	TYP NO	LENGTH MI	WIDTH FT	ACSC TYPE S9.5B	ACSC TYPE SF9.5A	BINDER GRADE PG 64-22
								TONS	TONS	
4CR.20511.14	JOHNSTON	1	SR 1140	FROM: 1144 - TO: SR 1139	1	1.70	20	1,152		75
		2	SR 1334	FROM: SR 1330 - TO: SR 1333	1	1.00	20	698		45
		3	SR 1350	TO: SR 1162 - TO: SR 1330	1	3.99	23	3,272		213
		4	SR 1570	FROM: US 70 - TO: SR 1563	1	1.05	22	798		52
		5	SR 1618	FROM: SR 1546 - TO: SR 1621	1	0.48	18	330		21
		6	SR 1619	FROM: SR 1618 - TO: SR 1620	1	0.44	18	357		23
		7	SR 1620	FROM: SR 1546 - TO: SR 1619	1	0.17	18	149		10
		8	SR 1621	FROM: SR 1619 - TO: CUL-DE-SAC	1	0.13	18	126		8
		9	SR 1624	FROM: SR 1552 - TO: CUL-DE-SAC	1	0.36	20	283		18
		10	SR 1666	FROM: SR 1624 - TO: CUL-DE-SAC	1	0.23	20	199		13
		11	SR 1667	FROM: SR 1666 - TO: DEAD END	1	0.34	20	270		18
		12	SR 1668	FROM: SR 1667 - TO: CUL-DE-SAC	1	0.09	20	58		4
		13	SR 1709	FROM: SR 1552 - TO: SR 1700	1	1.38	20	944		61
		14	SR 1945	FROM: NC 96 - TO: SR 1947	1	1.55	21	1,104		72
		15	SR 2369	FROM: SR 2342 - TO: SR 2320	1	1.46	20	1,046		68
		16	SR 2375	FROM: US 70 - TO: CUL-DE-SAC	2	0.37	20	417		25
		17	SR 2383	FROM: SR 2393 - TO: RXR SIDEING	1	0.40	20	299		19
		18	SR 2410	FROM: SR 2393 - TO: END MAINT.	1	0.14	21	105		7
		19	SR 1178	FROM: BEGIN TWO LANE SECTION APPROX. 1060 FT. EAST OF I-95 BRIDGE TO: US 701	1	1.66	20	1,236		80
		20	SR 2170	FROM: SR 1934 - TO: SR 2153	1	0.30	20	194		13
TOTAL FOR WBS ELEMENT 4CR.20511.14						17.24		417		845
GRAND TOTAL						17.24				

WBS ELEMENT	SHEET NO.	TOTAL SHEETS
4CR.2051.14	1	4
WBS ELEMENT	F. A. PROJ. NO.	DESCRIPTION
4CR.2051.14		

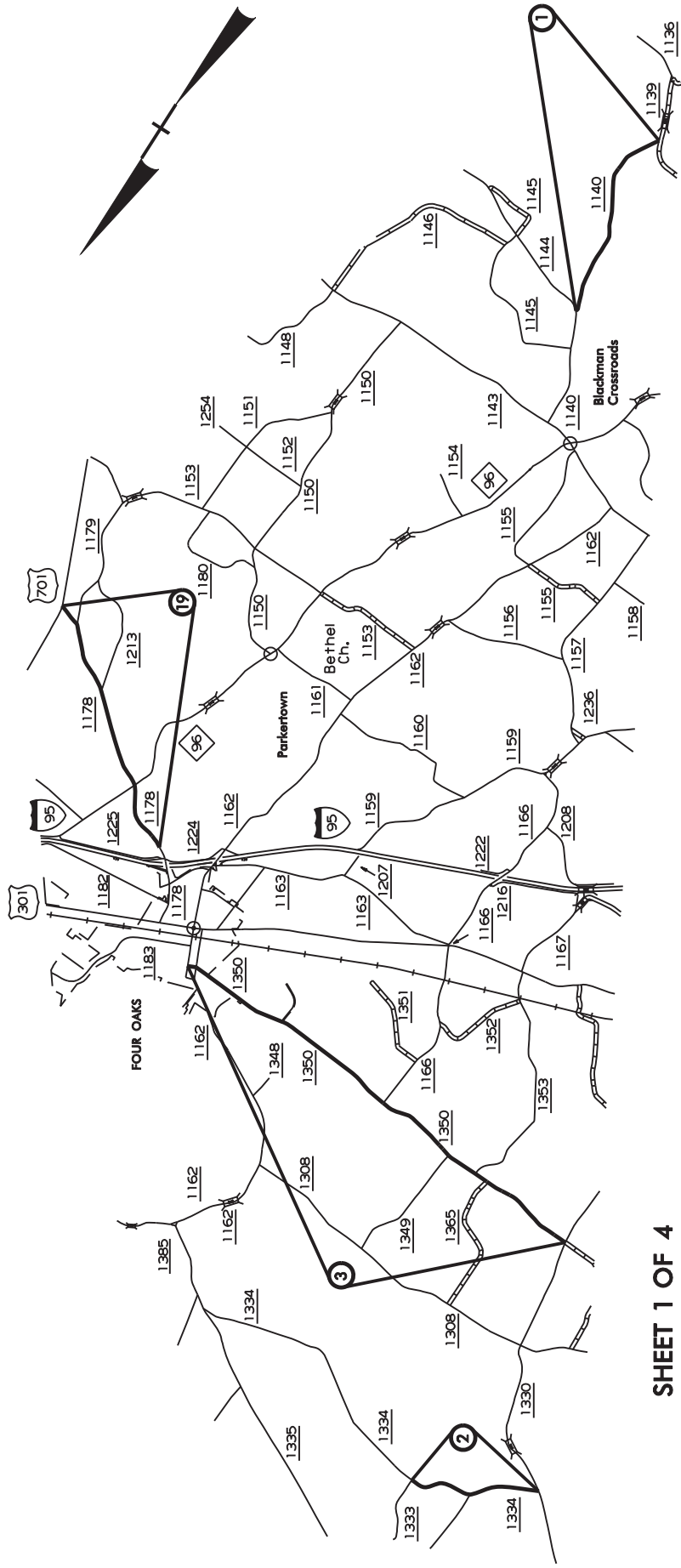

SHEET 1 OF 4
JOHNSTON COUNTY
 NORTH CAROLINA

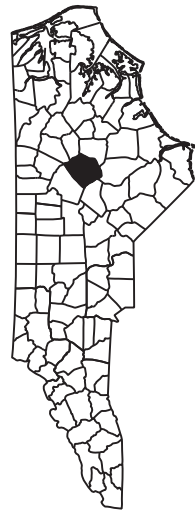

WBS ELEMENT 4CR.20511.14	SHEET NO. 2	TOTAL SHEETS 4
WBS ELEMENT F. A. PROJ. NO. 4CR.20511.14	DESCRIPTION	

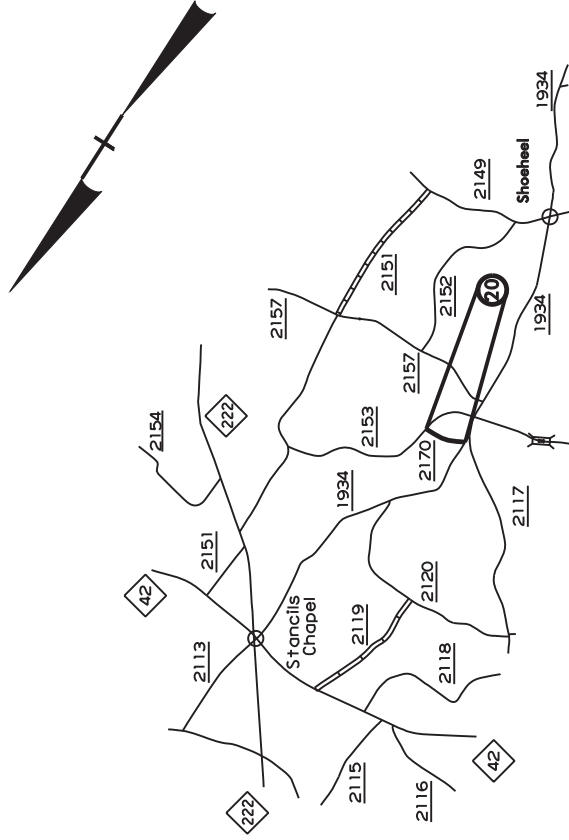
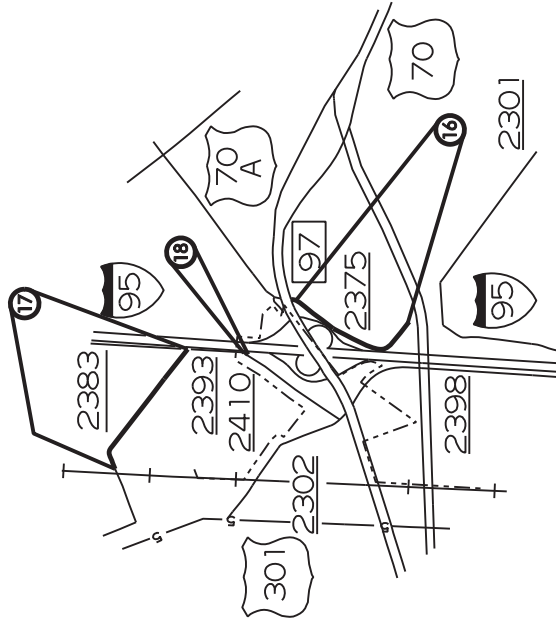

SHEET 2 OF 4
JOHNSTON COUNTY
 NORTH CAROLINA

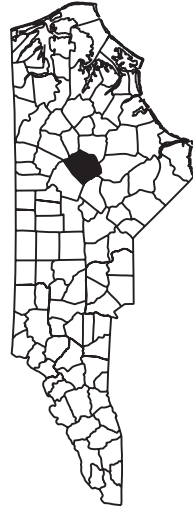

WBS ELEMENT	SHEET NO.	TOTAL SHEETS
4CR.20511.14	3	4
WBS ELEMENT	F. A. PROJ. NO.	DESCRIPTION
4CR.20511.14		

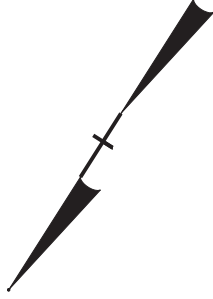

SHEET 3 OF 4
JOHNSTON COUNTY
 NORTH CAROLINA

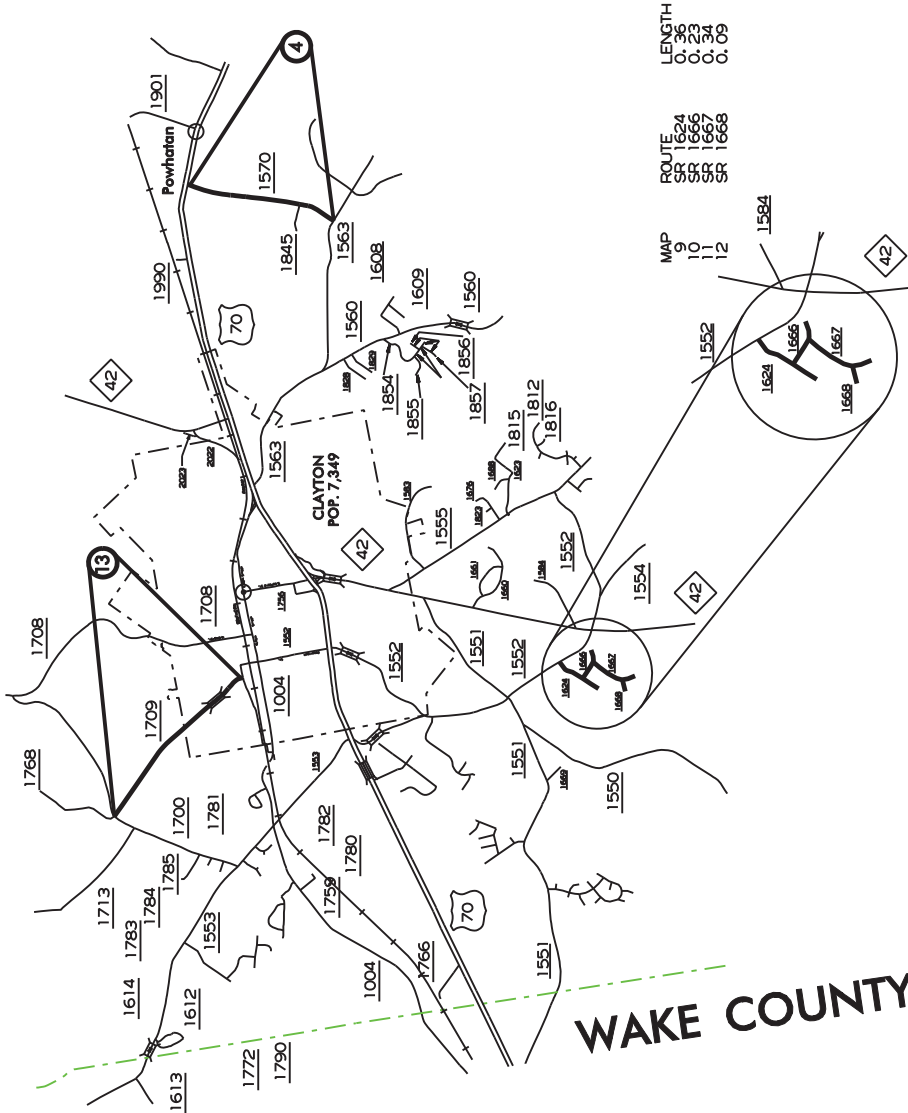
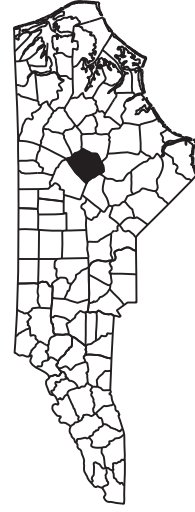

WBS ELEMENT 4CR.20511.14	SHEET NO. 4	TOTAL SHEETS 4
WBS ELEMENT F. A. PROJ. NO. 4CR.20511.14	DESCRIPTION	

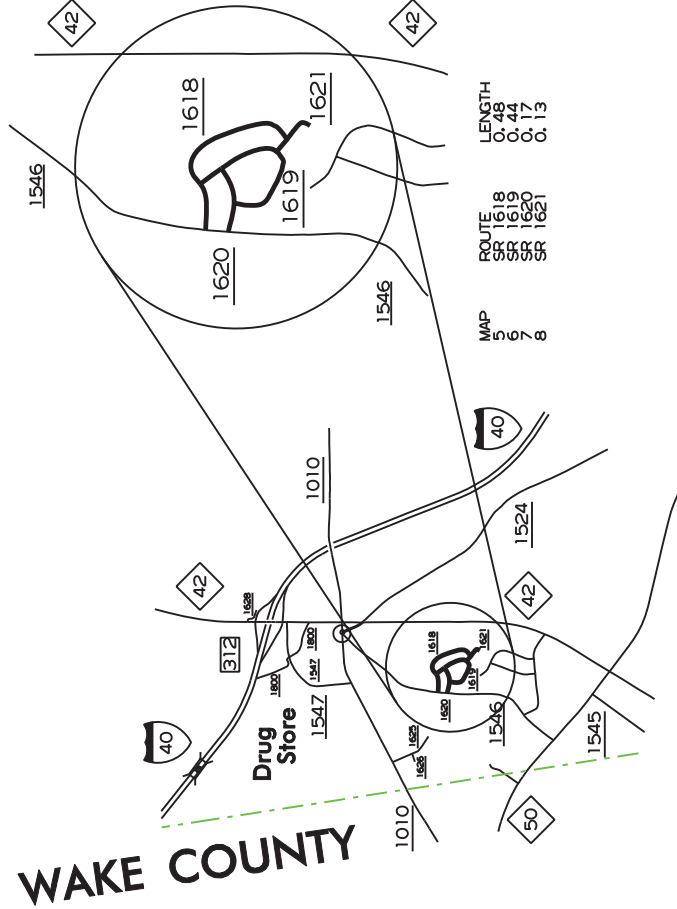

MAP	ROUTE	LENGTH
5	SR 1618	0.48
6	SR 1619	0.44
7	SR 1620	0.17
8	SR 1621	0.13

WAYNE COUNTY

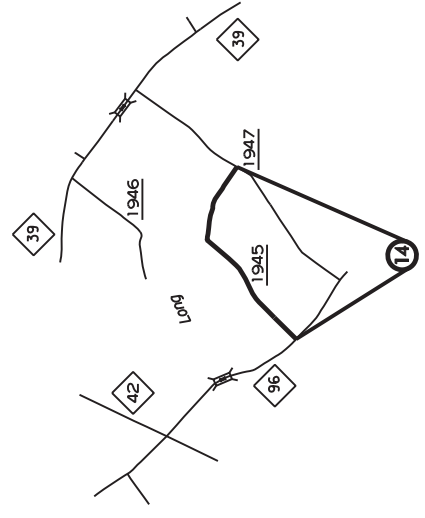
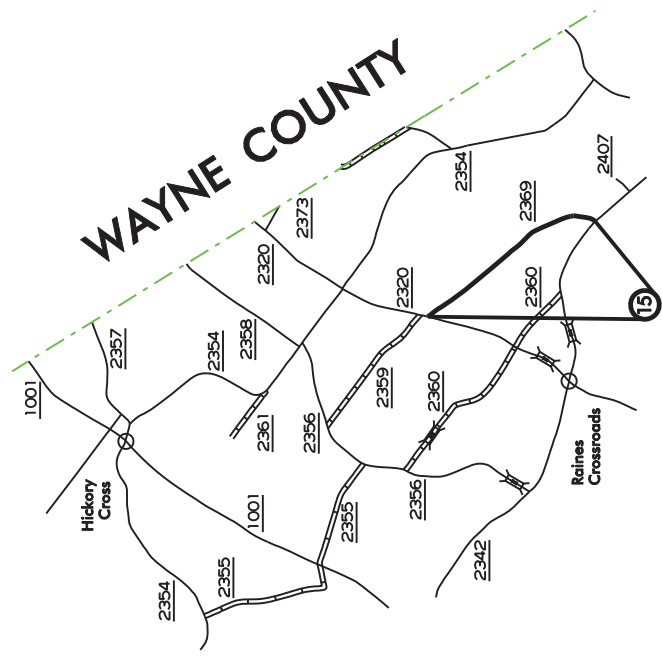

SHEET 4 OF 4 JOHNSTON COUNTY NORTH CAROLINA

